

Cole ———  
 Dallas - - -  
 1300 levels

Cole  
 &  
 Dallas Mines  
 Bisbee, Ariz

1" = 500'

coordinate squares  
are 1" X 1" on the  
original map

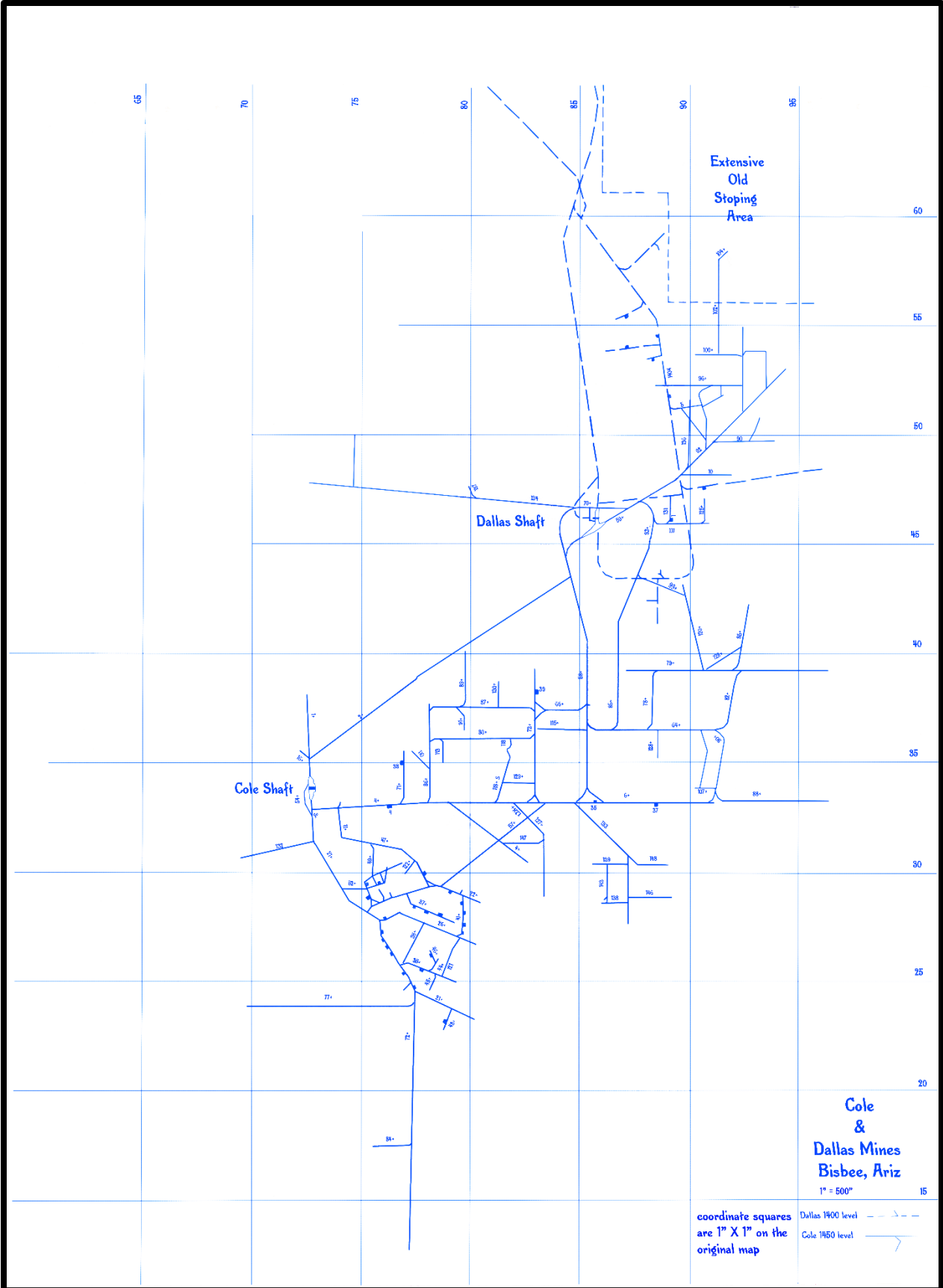

Extensive  
Old  
Stopping  
Area

Dallas Shaft

Cole Shaft

Cole  
&  
Dallas Mines  
Bisbee, Ariz

1" = 500'

coordinate squares  
are 1" X 1" on the  
original map

Dallas 1400 level - - - -  
Cole 1480 level ————

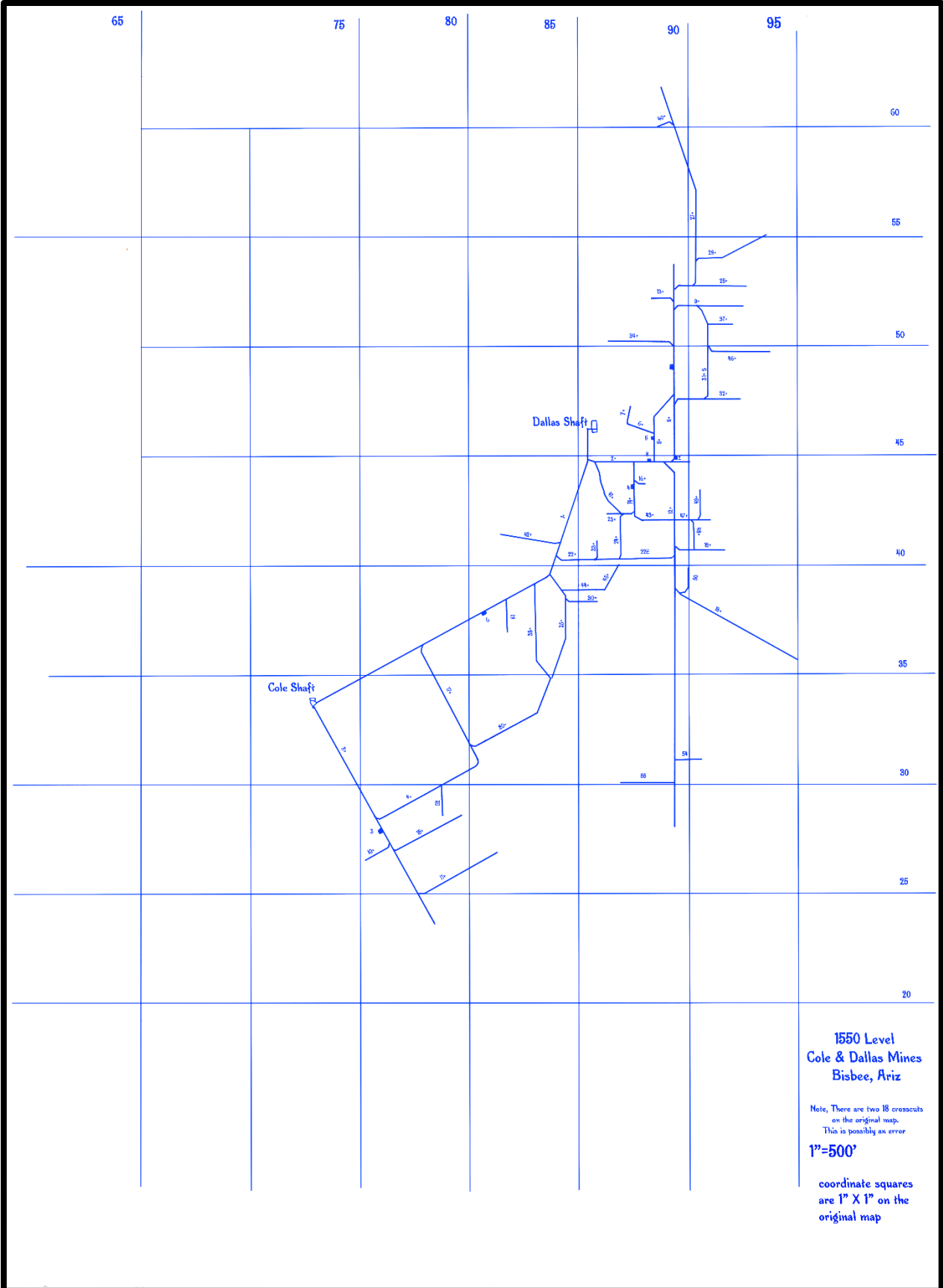

**1550 Level  
Cole & Dallas Mines  
Bisbee, Ariz**

Note, There are two 18 crosscuts  
on the original map.  
This is possibly an error

**1"=500'**

coordinate squares  
are 1" X 1" on the  
original map

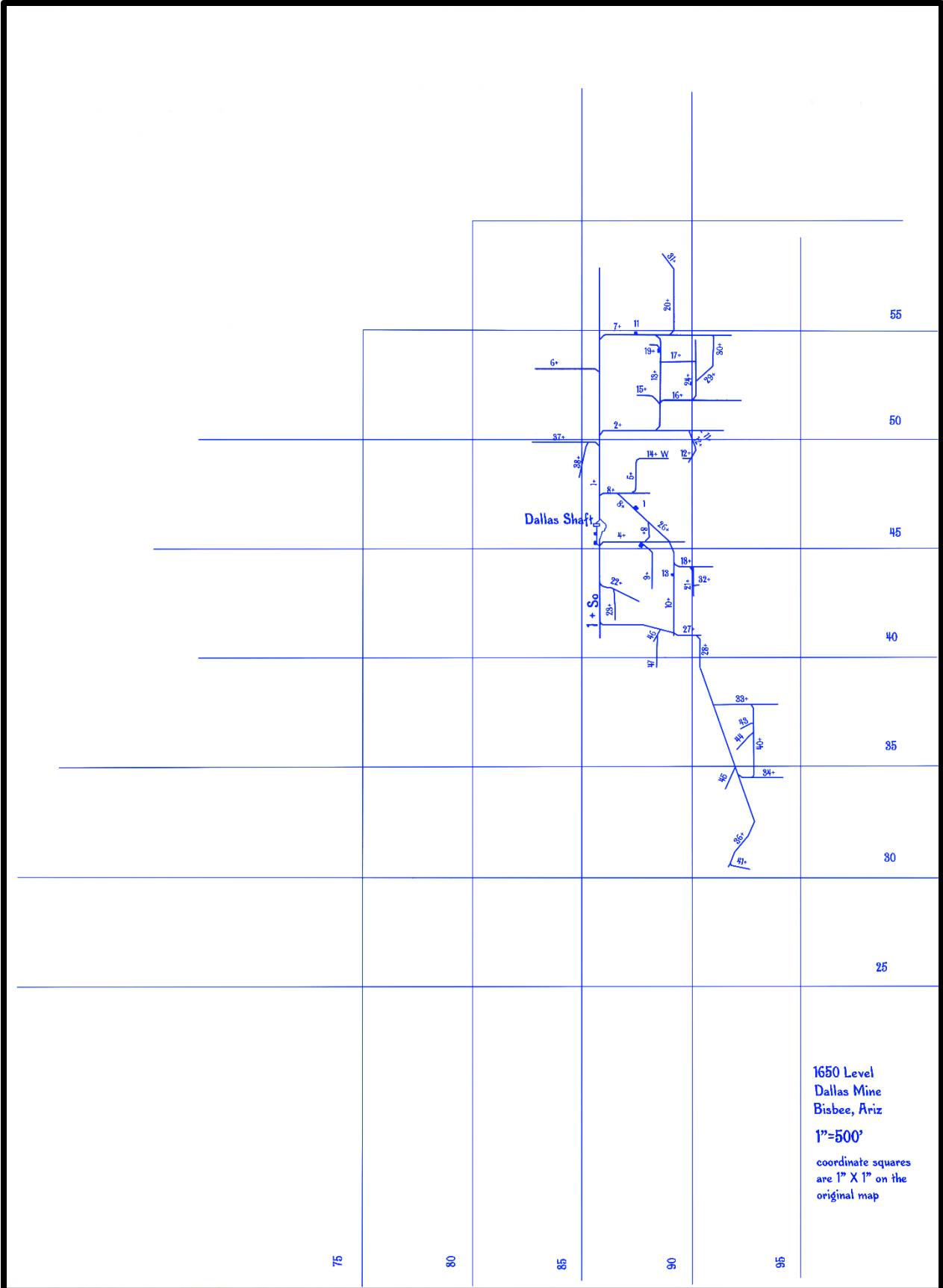

1650 Level  
 Dallas Mine  
 Bisbee, Ariz  
 1"=500'  
 coordinate squares  
 are 1" X 1" on the  
 original map

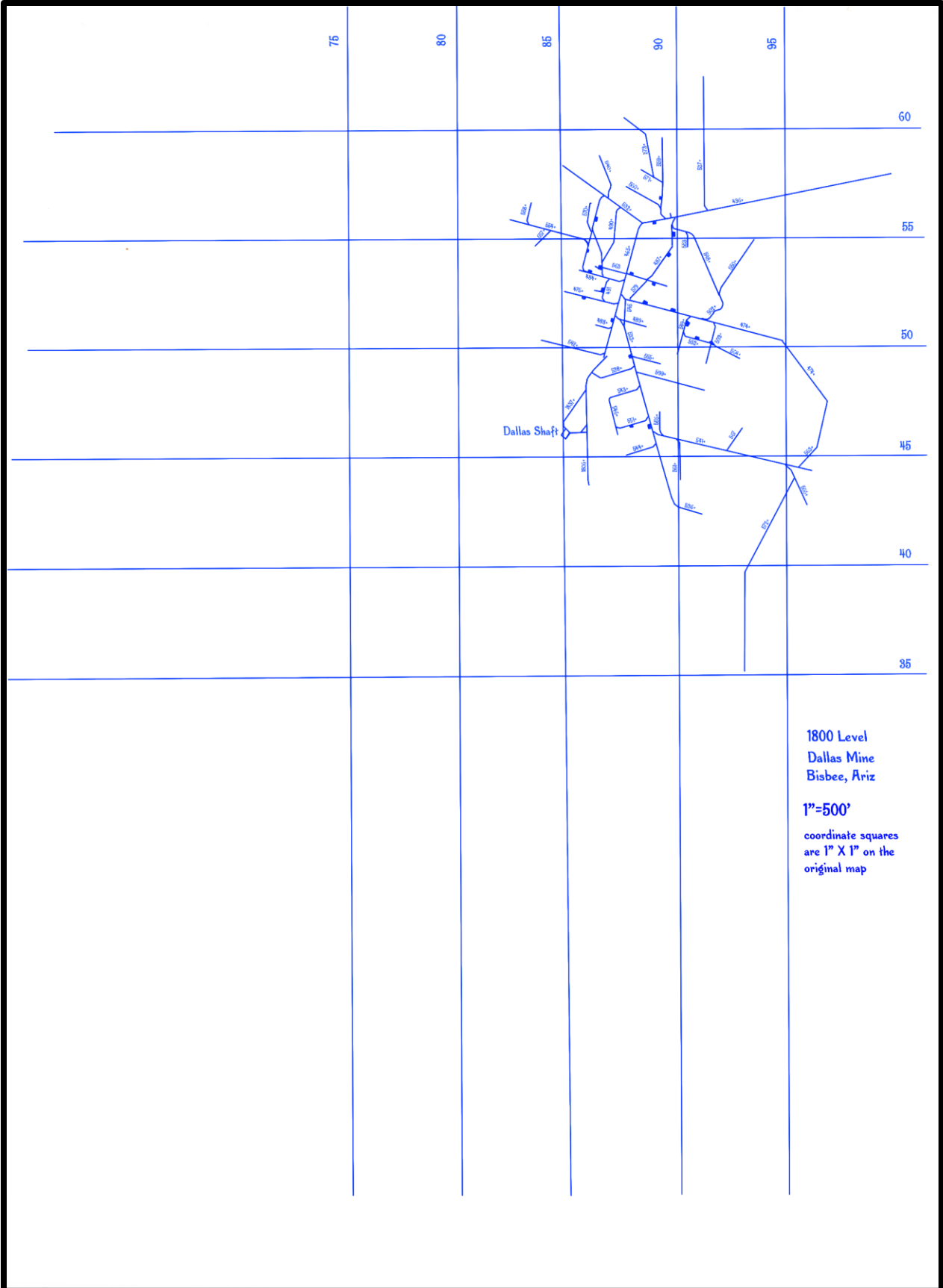

1800 Level  
Dallas Mine  
Bisbee, Ariz

1"=500'  
coordinate squares  
are 1" X 1" on the  
original map

